

**97.1 x 95 x 33mm**

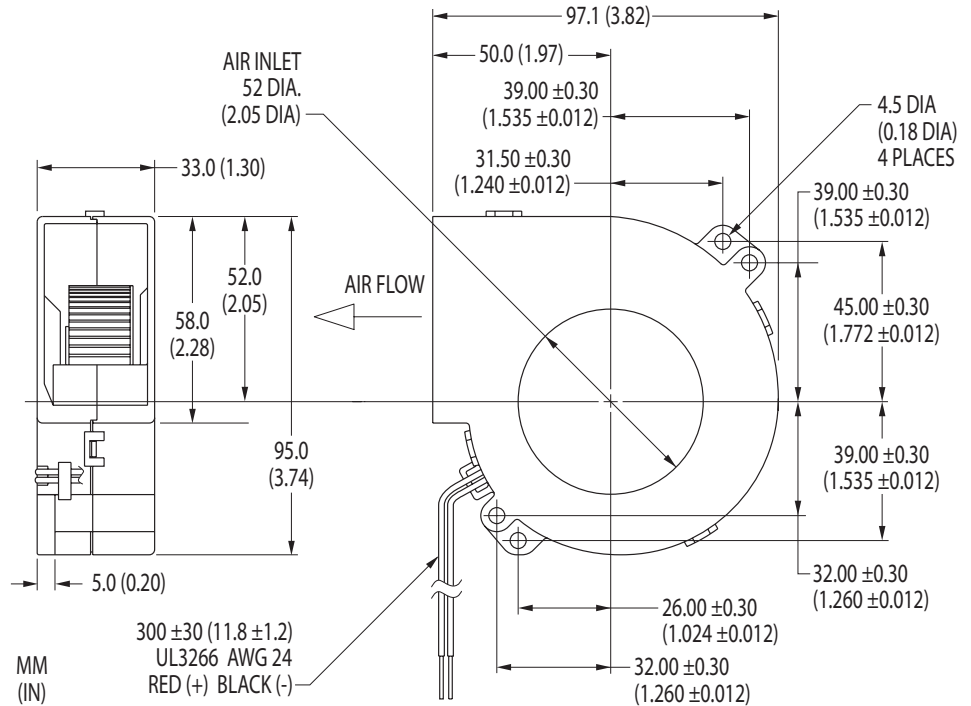

**E1033H/L Series**

- ✓ Air Flow to 44 CFM
- ✓ Static Pressure to 3.4 inwg
- ✓ Tach, Locked Rotor Alarm, and PWM Speed Control Options
- ✓ Permanently Lubricated, Shielded, Dual Ball Bearings



**Centrifugal Blowers**

Model	Air Flow (CFM)	Max. Static Pressure (inwg)	Operating Voltage		Operating Current (A)	Input Power (W)	Fan Speed (rpm)	Sound Pressure (dBA)	Operating Temp.		L10 Life† (hours)
			Nominal (V)	Range (V)					Min. (°C)	Max. (°C)	
E1033L12BCAZ-00	44	3.36	12	8.4-13.2	1.95	23.4	5800	62	-20	+70	80,000
E1033L24BCAZ-00	44	3.36	24	12.0-26.4	0.95	22.3	5800	62	-20	+70	80,000
E1033L12BBAZ-00	41	2.81	12	8.4-13.2	1.40	16.8	5300	60	-20	+70	80,000
E1033L24BBAZ-00	41	2.81	24	12.0-26.4	0.70	16.8	5300	60	-20	+70	80,000
E1033H24BAAZ-00	40	2.01	24	16.0-26.4	0.63	15.1	4850	58	-20	+60	80,000
E1033H12B8AZ-00	30	1.29	12	4.5-13.2	0.77	9.2	3450	51	-20	+70	80,000
E1033H24B8AZ-00	30	1.29	24	10.0-26.4	0.39	9.4	3450	51	-20	+70	80,000
E1033H12B7AZ-00	27	1.05	12	5.0-13.2	0.59	7.1	3100	48	-20	+70	80,000
E1033H24B7AZ-00	27	1.05	24	10.0-26.4	0.30	7.2	3100	48	-20	+70	80,000
E1033H24B6AZ-00	23	0.74	24	10.0-26.4	0.22	5.3	2600	46	-20	+70	80,000

Air flow, current, speed and sound pressure ratings are at nominal operating voltage and zero static pressure. † L10 bearing life expectancy at  $T_A = +40^\circ\text{C}$ . At  $+60^\circ\text{C}$ , the life expectancy is 40,000 hours. N/BAC



All for dreams

Nidec America Corporation · phone 781-848-0970 · email fans@nidecamerica.com · www.nidecamerica.com

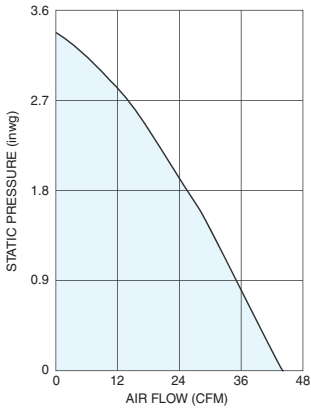

E1033L...CAZ

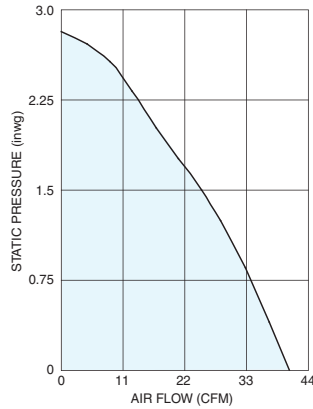

E1033L...BAZ

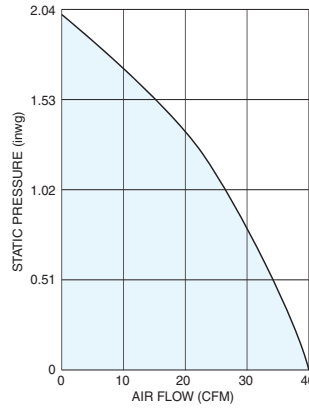

E1033H...AAZ

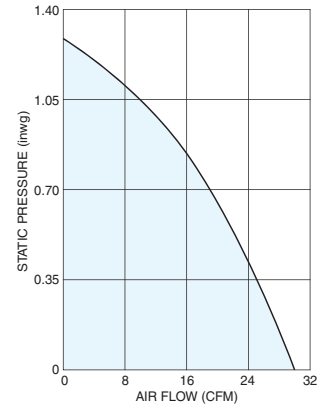

E1033H...8AZ

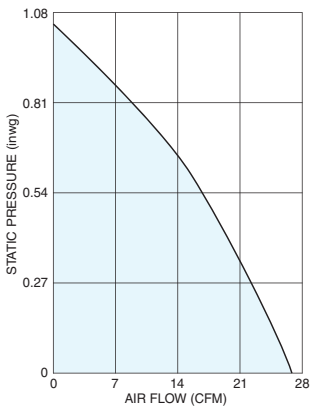

E1033H...7AZ

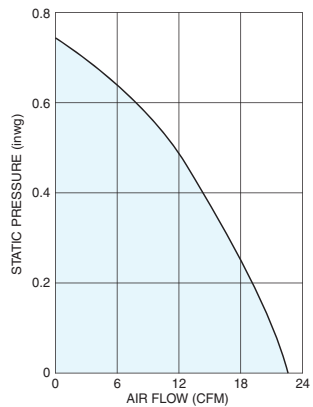

E1033H...6AZ

**BLOWER SPEED AS A FUNCTION OF PWM DUTY CYCLE**

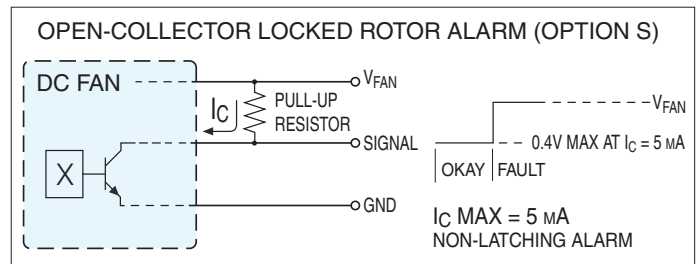
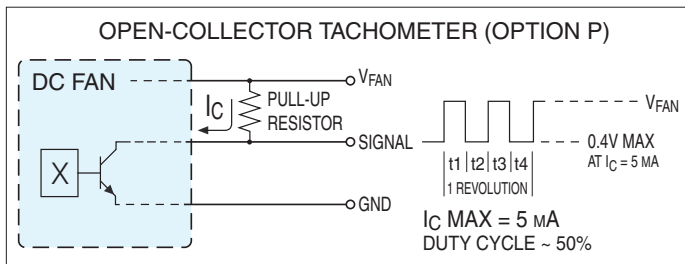
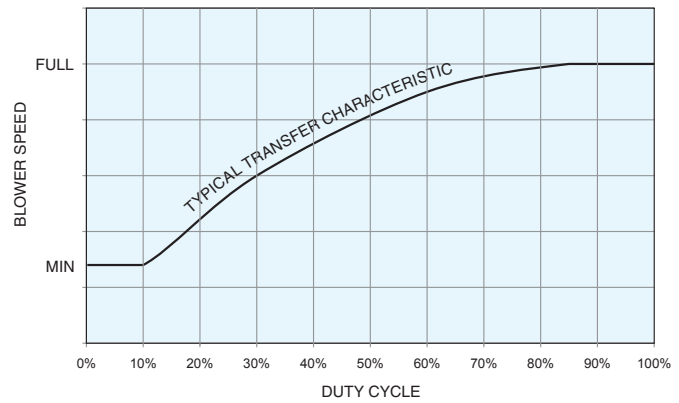

To specify an open-collector tachometer circuit (two square wave pulses per revolution, 50 percent duty cycle) terminated in a third lead wire, change the last letter of the model name to a "P."

For an open-collector, low-pass/high-fail locked rotor alarm circuit terminated in a third lead wire, change the model name's last letter to "S."

A combination of options – a pulse-width modulated speed control circuit and an open-collector tachometer circuit – is specified by making "ZP" the last two letters of the model name.

For a pulse-width modulated speed control circuit with an open-collector low-pass/high-fail locked rotor alarm circuit, make "ZS" the last two letters of the model name.

